

Luxembourg-Gasperich – Cessage gasperich Howald

## Office space for rent

*Property ID: LU881800089\_7*

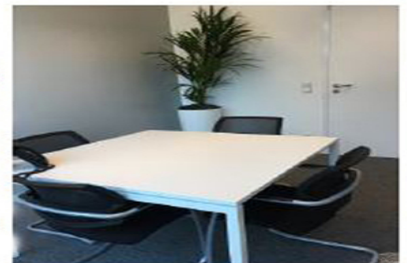
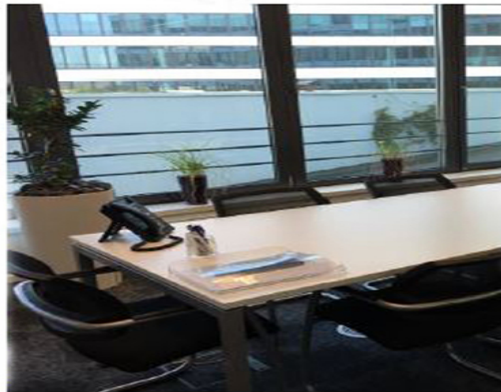
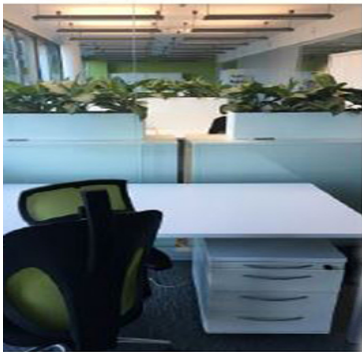
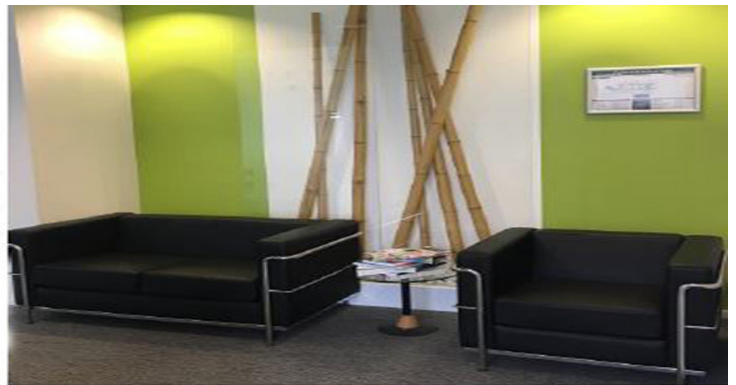

Property ID: LU881800089\_7 - L-1882 Luxembourg-Gasperich – Cessage gasperich Howald

- At a glance
- The property
- Floor plans
- A first impression
- Contact partner

Property ID: LU881800089\_7 - L-1882 Luxembourg-Gasperich – Cessage gasperich Howald

## At a glance

Property ID	LU881800089_7	Commission	Un mois à la charge du propriétaire.
Available from	According to the arrangement	Total Space	ca. 19 m <sup>2</sup>
Type of parking	4 x Other	Usable Space	ca. 0 m <sup>2</sup>

Property ID: LU881800089\_7 - L-1882 Luxembourg-Gasperich – Cessage gasperich Howald

## Floor plans

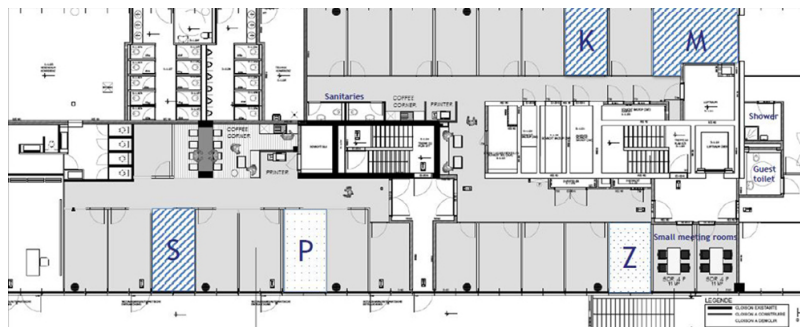

This floor plan is not to scale. The documents were given to us by the client. For this reason, we cannot guarantee the accuracy of the information.

Property ID: LU881800089\_7 - L-1882 Luxembourg-Gasperich – Cessage gasperich Howald

## A first impression

Beautiful office area fully furnished and equipped. You just have to install and plugger. One part is private and consists of a fully furnished open space and 267 m<sup>2</sup> shared common area (sanitary, kitchen, informal area, reception and meeting room) 4 parking spaces complete the set.

Property ID: LU881800089\_7 - L-1882 Luxembourg-Gasperich – Cessage gasperich Howald

## Contact partner

For further information, please contact your contact person:

VON POLL REAL ESTATE Limpertsberg

---

6, avenue Pasteur Limpertsberg  
E-Mail: [limpertsberg@von-poll.com](mailto:limpertsberg@von-poll.com)

*To Disclaimer of von Poll Immobilien GmbH*

---

[www.von-poll.com](http://www.von-poll.com)